

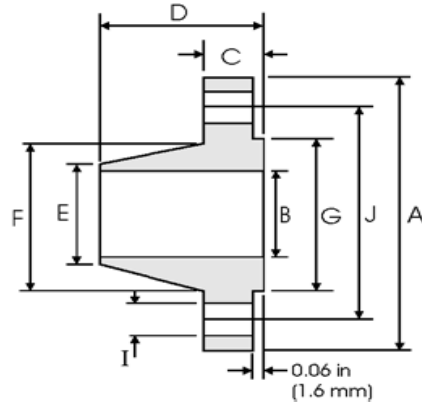

## WELDNECK FLANGES ACC TO ANSI B16.5



### Class 150 lb

| Nominal Pipe Size | Pipe  |                  | Flange Data                  |                      |                | Hub Data               |                | Raised Face    | Drilling Data   |                    |                             | Weight  |
|-------------------|---|------------------|------------------------------|----------------------|----------------|------------------------|----------------|----------------|-----------------|--------------------|-----------------------------|---|
|                   |  | <b>A</b>         | <b>B</b>                     | <b>C</b>             | <b>D</b>       | <b>E</b>               | <b>F</b>       | <b>G</b>       | <b>H</b>        | <b>I</b>           | <b>J</b>                    |  |
|                   | Outside Diameter  | Overall Diameter | Inside Diameter              | Flange Thickness min | Overall Length | Diameter at Weld Bevel | Hub Diameter   | Face Diameter  | Number of Holes | Bolt Hole Diameter | Diameter of Circle of Holes | kg/ piece   |
| in mm             | in mm   | in mm            | in mm                        | in mm                | in mm          | in mm                  | in mm          | in mm          |                 | in mm              | in mm                       |   |
| 1/2               | 0.840<br>21.30  | 3.500<br>88.90   | 0.620<br>15.70               | 0.440<br>11.20       | 1.880<br>47.80 | 0.840<br>21.30         | 1.190<br>30.20 | 1.380<br>35.00 | 4               | 0.620<br>15.70     | 2.380<br>60.45              | 0.48  |
| 3/4               | 1.050<br>26.70  | 3.880<br>98.60   | 0.820<br>20.80               | 0.500<br>12.70       | 2.060<br>52.30 | 1.050<br>26.70         | 1.500<br>38.10 | 1.690<br>42.90 | 4               | 0.620<br>15.70     | 2.750<br>69.85              | 0.71  |
| 1                 | 1.315<br>33.40  | 4.250<br>108.0   | 1.050<br>26.70               | 0.560<br>14.20       | 2.190<br>55.60 | 1.320<br>33.50         | 1.940<br>49.30 | 2.000<br>50.80 | 4               | 0.620<br>15.70     | 3.120<br>79.25              | 1.01  |
| 1 1/4             | 1.660<br>42.20  | 4.620<br>117.3   | 1.380<br>35.10               | 0.620<br>15.70       | 2.250<br>57.15 | 1.660<br>42.20         | 2.310<br>58.70 | 2.500<br>63.50 | 4               | 0.620<br>15.70     | 3.500<br>88.90              | 1.33  |
| 1 1/2             | 1.900<br>48.30  | 5.000<br>127.0   | 1.610<br>40.90               | 0.690<br>17.50       | 2.440<br>62.00 | 1.900<br>48.30         | 2.560<br>65.00 | 2.880<br>73.15 | 4               | 0.620<br>15.70     | 3.880<br>98.60              | 1.72  |
| 2                 | 2.375<br>60.30  | 6.000<br>152.4   | 2.070<br>52.60               | 0.750<br>19.10       | 2.500<br>63.50 | 2.380<br>60.45         | 3.060<br>77.70 | 3.620<br>91.90 | 4               | 0.750<br>19.10     | 4.750<br>120.7              | 2.58  |
| 2 1/2             | 2.875<br>73.00  | 7.000<br>177.8   | 2.470<br>62.70               | 0.880<br>22.40       | 2.750<br>69.85 | 2.880<br>73.15         | 3.560<br>90.40 | 4.120<br>104.6 | 4               | 0.750<br>19.10     | 5.500<br>139.7              | 4.11  |
| 3                 | 3.500<br>88.90  | 7.500<br>190.5   | 3.070<br>78.00               | 0.940<br>23.90       | 2.750<br>69.85 | 3.500<br>88.90         | 4.250<br>108.0 | 5.000<br>127.0 | 4               | 0.750<br>19.10     | 6.000<br>152.4              | 4.92  |
| 3 1/2             | 4.000<br>101.6  | 8.500<br>215.9   | 3.550<br>90.20               | 0.940<br>23.90       | 2.810<br>71.40 | 4.000<br>101.6         | 4.810<br>122.2 | 5.500<br>139.7 | 8               | 0.750<br>19.10     | 7.000<br>177.8              | 6.08  |
| 4                 | 4.500<br>114.3  | 9.000<br>228.6   | 4.030<br>102.4               | 0.940<br>23.90       | 3.000<br>76.20 | 4.500<br>114.3         | 5.310<br>134.9 | 6.190<br>157.2 | 8               | 0.750<br>19.10     | 7.500<br>190.5              | 6.84  |
| 5                 | 5.563<br>141.3  | 10.00<br>254.0   | 5.050<br>128.3               | 0.940<br>23.90       | 3.500<br>88.90 | 5.560<br>141.2         | 6.440<br>163.6 | 7.310<br>185.7 | 8               | 0.880<br>22.40     | 8.500<br>215.9              | 8.56  |
| 6                 | 6.625<br>168.3  | 11.00<br>279.4   | 6.070<br>154.2               | 1.000<br>25.40       | 3.500<br>88.90 | 6.630<br>168.4         | 7.560<br>192.0 | 8.500<br>215.9 | 8               | 0.880<br>22.40     | 9.500<br>241.3              | 10.6  |
| 8                 | 8.625<br>219.1  | 13.50<br>342.9   | 7.980<br>202.7               | 1.120<br>28.40       | 4.000<br>101.6 | 8.630<br>219.2         | 9.690<br>246.1 | 10.62<br>269.7 | 8               | 0.880<br>22.40     | 11.75<br>298.5              | 17.6  |
| 10                | 10.75<br>273.0  | 16.00<br>406.4   | 10.02<br>254.5               | 1.190<br>30.20       | 4.000<br>101.6 | 10.75<br>273.0         | 12.00<br>304.8 | 12.75<br>323.8 | 12              | 1.000<br>25.40     | 14.25<br>362.0              | 24.0  |
| 12                | 12.75<br>323.8  | 19.00<br>482.6   | 12.00<br>304.8               | 1.250<br>31.75       | 4.500<br>114.3 | 12.75<br>323.8         | 14.38<br>365.3 | 15.00<br>381.0 | 12              | 1.000<br>25.40     | 17.00<br>431.8              | 36.5  |
| 14                | 14.00<br>355.6  | 21.00<br>533.4   | To be specified by Purchaser | 1.380<br>35.10       | 5.000<br>127.0 | 14.00<br>355.6         | 15.75<br>400.1 | 16.25<br>412.7 | 12              | 1.120<br>28.40     | 18.75<br>476.3              | 48.4  |
| 16                | 16.00<br>406.4  | 23.50<br>596.9   |                              | 1.440<br>36.60       | 5.000<br>127.0 | 16.00<br>406.4         | 18.00<br>457.2 | 18.50<br>469.9 | 16              | 1.120<br>28.40     | 21.25<br>539.8              | 60.6  |
| 18                | 18.00<br>457.2  | 25.00<br>635.0   |                              | 1.560<br>39.60       | 5.500<br>139.7 | 18.00<br>457.2         | 19.88<br>505.0 | 21.00<br>533.4 | 16              | 1.250<br>31.75     | 22.75<br>577.9              | 68.3  |
| 20                | 20.00<br>508.0  | 27.50<br>698.5   |                              | 1.690<br>42.90       | 5.690<br>144.5 | 20.00<br>508.0         | 22.00<br>558.8 | 23.00<br>584.2 | 20              | 1.250<br>31.75     | 25.00<br>635.0              | 84.5  |
| 24                | 24.00<br>609.6  | 32.00<br>812.8   |                              | 1.880<br>47.80       | 6.000<br>152.4 | 24.00<br>609.6         | 26.12<br>663.4 | 27.25<br>692.1 | 20              | 1.380<br>35.10     | 29.50<br>749.3              | 115   |

#### Notes

- Dimension B corresponds to the pipe inside diameter. Values quoted assume 40S/Standard wall thickness.
- Weights are based on manufacturer's data and are approximate.
- Flat face flanges may be provided at full thickness, C, or with raised face removed (the latter is nonstandard).
- For ring joint facings see page 8-6. For weld end bevel see page 8-5.